

Space for Lease Information:

3925 N. I-10 Service Rd. W.
Metairie, LA 70002

Suite: 224

RSF: 831

Comments:

Two private offices and an open area that could service as a meeting room or reception area.

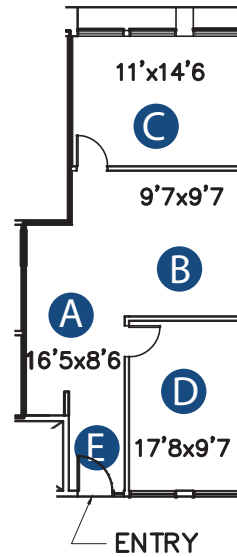

A



B



C



D



E



Contact

Susan K. Wallace or Donna Gaudet
1st Lake Commercial Properties, Inc.
3925 N. I-10 Service Rd. Suite 130
Metairie, LA 70002
504.455.8644 Fax: 504.885.4941
Licensed in the State of Louisiana

The foregoing is solely for information purposes and is subject to change without notice. Subject to errors, omissions, changes in terms and conditions prior to lease or withdrawal without notice.